

TZ 200.01

Bending device



Learning objectives/experiments

- technical drawing
 - ▶ familiarisation with three-dimensional views
 - ▶ production-oriented and standardised representation of parts
 - ▶ surface finish and tolerance specifications
 - ▶ overview drawing
 - ▶ parts list
 - ▶ standard parts
 - ▶ 3D views
 - ▶ material specifications
- technology
 - ▶ assembly and disassembly
 - ▶ planning an assembly sequence
 - ▶ functions
 - ▶ material selection
 - ▶ manufacturing methods
- measurement exercises
 - ▶ length measurements
 - ▶ angle measurements

Description

- functional bending device as a practice model providing an introduction to technical drawing
- introduction to simple assembly sequences
- suitable for a broad range of learning matter

The bending device model forms part of the extensive GUNT course providing an introduction to technical drawing. The didactic approach involves teaching the systematic and transferable learning matter based on an operational mechanism.

TZ 200.01 presents an eccentrically-operated bending device which can be used to press a clamp profile out of a sheet-metal strip. All parts are precision-manufactured on CNC machines. The surfaces of the steel parts have a gun-metal finish to prevent corrosion.

Comprehensive and well-structured instructional material supports wide-ranging use of the model in technical training. Optimal learning is established when one model is used with two/three students.

TZ 200.01

Bending device

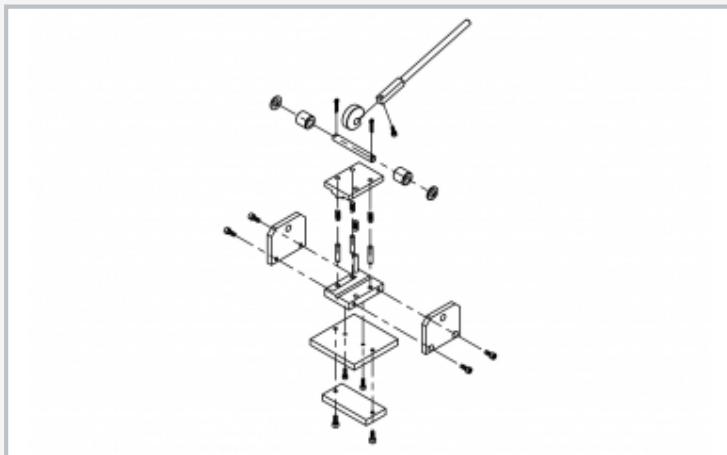

Exploded-view drawing of the bending device

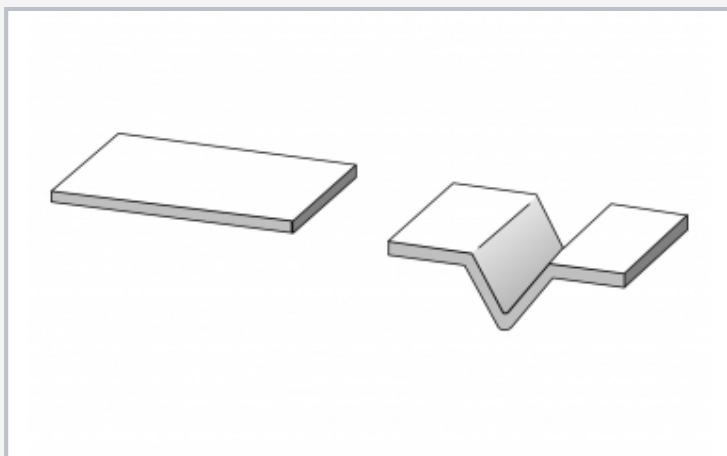

From sheet-metal strip to clamp profile, the product of the bending device

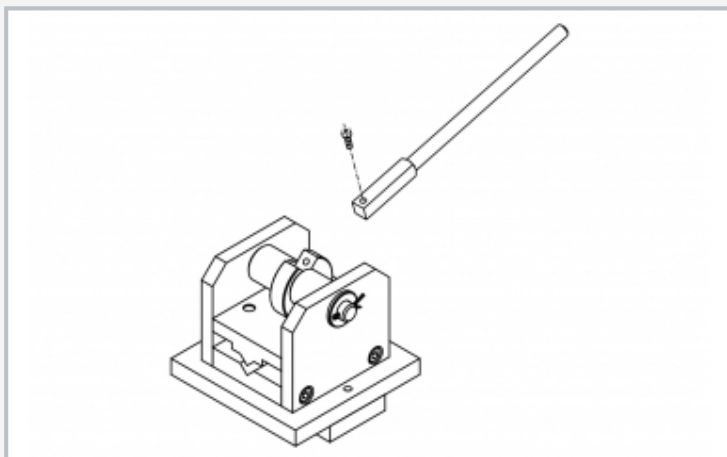

Assembly of the lever

Specification

- [1] part of the GUNT technical drawing course
- [2] functional bending device with eccentric operation
- [3] all components made from steel, precision-manufactured, with gunmetal surface finish
- [4] instructional material incorporates action-oriented and interdisciplinary forms of teaching

Technical data

LxWxH: 90x90x60mm (excluding lever)
 Weight: approx. 3kg

Scope of delivery

- 1 bending device, assembled
- 1 set of assembly/disassembly tools
- 1 set of instructional material